



PIPE FITTING AND FLANGE

TIANJIN MEICAI METAL CO.,LTD

Address: Room 1501-1502,Beichen Building 2,Beichen District,Tianjin,China
Tel: 86-22-26981589 26887199 Fax: 86-22-26888826
E-mail: sales1@meicaimetal.com sales2@meicaimetal.com
sales3@meicaimetal.com sales4@meicaimetal.com
Website: www.meicaimetal.com

TIANJIN MEICAI METAL CO.,LTD



WELCOME

ABOUT US

Tianjin Meicai Metal Trading Co. Ltd was founded in 2006, located in Beichen District, Tianjin, China. Our products have pipe fittings and flanges, qualified with different standards, such as ASTM, DIN & JIS and so on. The pipe fittings are Elbow, Equal & Reducing Tee, and Concentric & Eccentric Reducer. The flanges are SO, WN, SW, Blind and so on. The materials mainly contain carbon steel and stainless steel. All the products are widely used in the fields of oil, water, fire-fighting and daily life. The products have a good market in Canada, Southeast Asia, South American, West Europe and Middle East.

For years we insist on the management theory of quality first and customer supreme, and constantly improving our quality management system and devoting to meet our customers' different requirements.

We sincerely hope to cooperate with friend in every field both at home and abroad. We will keep our promise and faith, and try our best to realize mutual benefit and get more progress.

CONTENTS

PIPE FITTING

(02) PRODUCT EXHIBITION

(03) ELBOW OUTER DIAMETER AND WALL THICKNESS STANDARD

(04-14) ASME B18.9-1993
ASME B18.28-1994

(15-24) JIS B2311-1997
TOLERANCES ON ALIGNMENT OF PIPE FITTINGS

(25-28) DIN2605-1991 DIN2617-1991
DIN2615-1992 DIN2616-1991

FLANGE

ASME B16.5

(29-43) ASME B16.5 FLANGES
Class 150 Flanges
Class 300 Flanges
Class 400 Flanges
Class 600 Flanges
Class 900 Flanges
Class 1500 Flanges
Class 2500 Flanges

(44-47) LONG WELDING NECK FLANGES
Class 150/300 Flanges
Class 400/600 Flanges
Class 900/1500 Flanges
Class 2500 Flanges

(48-51) APPENDIX
Welded and Seamless Pipe, Carbon and Alloy Steel
Welded and Seamless Pipe, Stainless Steel
Material Specifications
Tolerance

ASME B16.47

(52-57) ASME B 16.47 SER. "B", API 605 FLANGES
Class 75/150 Flanges
Class 300 Flanges
Class 400 Flanges
Class 600 Flanges
Class 900 Flanges

(58-67) ASME B 16.47 SER. "A", MSS SP. 44 FLANGES
Class 150 Flanges
Class 300 Flanges
Class 400 Flanges
Class 600 Flanges
Class 900 Flanges

(68-71) DIN
6 bar
10 bar
16 bar
25 bar

CARBON STEEL PIPE FITTING

Name	Type	Specification ODXWT MM	Executive Standard	Main Application
CARBON STEEL PIPE FITTING	ELBOW TEE REDUCER CAP	O.D.:1/2" -24" Seamless 4" -60" Seam-welded W.T.:2.0MM-60MM	ASTM A234 WPB DIN2605,2615, 2616,2617 JIS B2311	Suitable for joining pipe lines of steam,gas,oil, air and are also used as apparatus for fencing and railing.



FLANGE

Name	Type	Specification ODXWT MM	Executive Standard	Main Application
FLANGE	SLIP ON WELDING NECK PLATE BLIND SOCKET WELDING LAP JOINT THREADED	O.D.:1/2" -24" DN15-DN3000 PRESSURE CLASS: 150LB-2500LB PN6-PN250	ANSI B16.5 EN1092-1:2007, ASME B16.47, DIN,GOST,B54504 (MATERIAL:CS/STAINLESS)	Used for the connection of all kinds of pipeline. To convey the water,steam,air, gas and oil etc.



PIPE FITTING



产品展示 Product exhibition



美标 90° 弯头 (长)
ASTM L/R 90° ELBOW



美标 90° 弯头 (短)
ASTM S/R 90° ELBOW



美标 45° 弯头 (长)
ASTM L/R 45° ELBOW



美标 45° 弯头 (短)
ASTM S/R 45° ELBOW



美标 等径三通
ASTM STRAIGHT TEE



美标 异径三通
ASTM REDUCING TEE



美标 同心大小头
ASTM CON REDUCER



美标 偏心大小头
ASTM ECC REDUCER



美标 180° 弯头 (长)
ASTM L/R 180° ELBOW



美标 180° 弯头 (短)
ASTM S/R 180° ELBOW



美标 管帽
ASTM CAP



美标 黑漆弯头
ASTM BLACK MATT ELBOW



日标 JIS B2311
L/R 90° ELBOW



日标 JIS B2311
S/R 90° ELBOW



日标 JIS B2311
CON REDUCER



日标 JIS B2311
STRAIGHT TEE



德标 DIN 2605
弯头 TYPE 5-5D



德标 DIN 2605
弯头 TYPE 3-3D



德标 异径三通
DIN 2615



德标 CAP
DIN 2617



德标 三通
DIN 2615



德标 同心大小头
DIN 2616



德标 偏心大小头
DIN 2616



镀锌弯头 L/R 90ELBW
GALVANIZED PIPE-FITTINGS

美标、日标、德标弯头外径与壁厚 单位mm
ELBOW OUTER DIAMETER AND WALL THICKNESS STANDARD(GERMANY USA, JAPAN)

NOMINAL PIPE SIZE		OUTSIDE DIAMETER				NOMINAL WALL THICKNESS													
A	B	ASME	JIS	DIN	JIS(I)	DIN(2)	SCH10	SCH20	SCH30	STD	SCH40	SCH60	XS	SCH80	SCH100	SCH120	SCH140	SCH160	XXS
15	1/2"	21.3	21.7	21.3	2.8	2.0	2.11		2.41	2.77	2.77		3.73	3.73				4.78	7.47
20	3/4	26.7	27.2	26.9	2.8	2.3	2.11		2.41	2.87	2.87		3.91	3.91				5.96	7.92
25	1	33.4	34.0	33.7	3.2	2.6	2.77		2.90	3.38	3.38		4.55	4.55				6.35	9.09
32	1 1/4	42.2	42.7	42.4	3.5	2.6	2.77		2.97	3.56	3.56		4.85	4.85				6.35	9.70
40	1 1/2	48.3	48.6	48.3	3.5	2.6	2.77		3.18	3.68	3.68		5.08	5.08				7.14	10.15
50	2	60.3	60.5	60.3	3.8	2.9	3.05		3.18	3.91	3.91		7.01	7.01				8.74	11.07
65	2 1/2"	73.0	76.3	76.1	4.2	2.9	3.05		4.78	5.16	5.16		7.62	7.62				9.53	14.02
80	3	88.9	89.1	88.9	4.2	3.2	3.05		4.78	5.49	5.49		8.08	8.08				11.13	15.24
90	3 1/2	101.6	101.6		4.2	3.05		4.78	5.74	5.74		8.08	8.08						
100	4"	114.3	114.3	114.3	4.5	3.6	3.05		4.78	6.02	6.02		8.56	8.56		11.13		13.49	17.12
125	5	141.3	139.8	139.7	4.5	4.0	3.40		6.55	6.55		9.53	9.53		12.70		15.88	19.05	
150	6	168.3	165.2	168.3	5.0	4.5	3.40	4.5	7.11	7.11		10.97	10.97		14.27		18.26	21.95	
200	8	219.1	216.3	219.1	5.8	6.3	3.76	6.35	7.04	8.18	8.18	10.31	12.70	12.70	15.09	18.26	20.62	23.01	22.23
250	10"	273.0	267.4	273.0	6.6	6.3	4.19	6.35	7.80	9.27	9.27	12.70	15.09	15.09	18.26	21.44	25.40	28.58	25.40
300	12"	323.8	318.5	323.9	6.9	7.1	4.57	6.35	8.38	9.53	10.31	14.27	17.48	17.48	21.44	25.40	28.58	33.32	25.40
350	14	355.6	355.6	355.6	7.9	8.0	6.35	7.92	9.53	9.53	11.13	15.09	17.48	17.48	21.44	25.40	28.58	35.71	
400	16"	406.4	406.4	406.4	7.9	8.8	6.35	7.92	9.53	9.53	12.70	16.66	19.05	19.05	23.83	27.79	31.75	35.71	
450	18"	457.2	457.2	457.0	7.9	10.0	6.35	9.53	12.70	9.53	15.09	20.62	22.23	22.23	27.79	31.75	35.71		
500	20"	508.0	508.0	508.0	7.9	11.0	6.35	9.53	12.70	9.53	17.48	24.61	26.19	26.19	31.75	35.71			
550	22"	558.8	558.8				6.35	9.53	12.70	9.53									
600	24	609.6	609.6	610.0		12.5	6.35	9.53	14.27	9.53									
650	26	660.4	660.4				7.92	12.70		9.53									
700	28"	711.2	711.2	711.0		12.5	7.92	12.70	15.88	9.53									
750	30"	762.0	762.0	762.0			7.92	12.70	15.88	9.53									
800	32"	812.8	812.8	813.0		12.5	7.92	12.70	15.88	9.53	17.48								
850	34	863.6	863.6				7.92	12.70	15.88	9.53	17.48								
900	36	914.4	914.4	914.0		12.5	7.92	12.70	15.88	9.53	19.05								
950	38"	965.2	965.2							9.53									
1000	40"	1016.0	1016.0	1016.0		12.5				9.53									
1050	42	1066.8	1066.8							9.53									
1100	44"	1117.6	1117.6							9.53									
1150	46	1168.4	1168.4							9.53									
1200	48"	1219.2	1219.2	1220.0						9.53									

JIS G3452 ASME B36.10M
JIS G3454 DIN2448
JIS G3455 DIN2458
JIS G3457

90° 长半径弯头
45° 长半径弯头
美标STD XS XXS

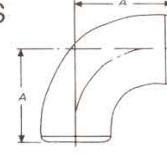

Elbows
Long Radius90°
Long Radius45°
ASME B16.9-1993

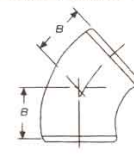

Nominal pipe Size NPS	Outside Diameter at Bevel D		Center to End				Approx Weight kg 重量					
	INCH	MM	90 deg ElbowsA		45 deg ElbowsB		90 deg Elbows			45 deg Elbows		
	INCH	MM	INCH	MM	INCH	MM	STD	XS	XXS	STD	XS	XXS
1/2	0.84	21	1.50	38	0.62	16	0.078	0.099		0.039	0.049	
3/4	1.05	27	1.12	29	0.44	11	0.103	0.134		0.052	0.067	
1	1.32	33	1.50	38	0.88	22	0.154	0.196		0.077	0.089	
1 1/4	1.66	42	1.88	48	1.00	25	0.260	0.341	0.589	1.30	0.170	0.295
1 1/2	1.90	48	2.25	57	1.12	29	0.368	0.492	0.868	0.184	0.246	0.434
2	2.38	60	3.00	76	1.38	35	0.652	0.891	1.62	0.326	0.445	0.808
2 1/2	2.88	73	3.75	95	1.75	44	1.37	1.79	3.22	0.683	0.895	1.61
3	3.50	89	4.50	114	2.00	51	2.04	2.74	4.97	1.02	1.37	2.49
3 1/2	4.00	102	5.25	133	2.25	57	2.82	3.91		1.41	1.95	
4	4.50	114	6.00	152	2.50	64	3.84	5.36	9.81	1.92	2.68	4.90
5	5.56	141	7.50	190	3.12	79	6.48	9.13	16.9	3.24	4.57	8.46
6	6.62	168	9.00	229	3.75	95	9.94	15.0	27.8	4.97	7.50	13.9
8	8.62	219	12.00	305	5.00	127	20.1	30.5	50.8	10.1	15.3	25.4
10	10.75	273	15.00	381	6.25	159	35.4	47.7		17.7	23.9	
12	12.75	324	18.00	457	7.50	190	52.0	68.7		26.0	34.0	
14	14.00	356	21.00	533	8.75	222	67.9	89.9		34.0	45.0	
16	16.00	406	24.00	610	10.00	254	89.0	118		44.5	59.0	
18	18.00	457	27.00	686	11.25	286	113	150		56.5	74.9	
20	20.00	508	30.00	762	12.50	318	140	186		69.9	92.8	
22	22.00	559	33.00	838	13.50	343	169	225		84.7	113	
24	24.00	610	36.00	914	15.00	381	202	268		101	134	-
26	26.00	660	39.00	991	16.00	406	237	315		119	158	
28	28.00	711	42.00	1067	17.25	438	275	366		138	183	
30	30.00	762	45.00	1143	18.50	470	316	421		158	211	
32	32.00	813	48.00	1219	19.75	502	360	480		180	240	
34	34.00	864	51.00	1295	21.00	533	407	542		203	271	-
36	36.00	914	54.00	1372	22.25	565	457	608		228	304	
38	38.00	965	57.00	1448	23.62	600	509	678		254	339	
40	40.00	1016	60.00	1524	24.88	632	564	752		282	376	
42	42.00	1067	63.00	1600	26.00	660	622	828		311	414	
44	44.00	1118	66.00	1676	27.38	695	683	911		342	455	
46	46.00	1168	69.00	1753	28.62	727						
48	48.00	1219	72.00	1829	29.88	759	814	1085		-	407	542

NOTE (1) THE WALL THICKNESS SPECIFIED IS GRADE IS GRADE F50 OF JIS B2311, 1997
(2) THE WALL THICKNESS SPECIFIED IS FOR SERIES 3 OF DIN 2605 (PART 1), 02.91

90° 短半径弯头
180° ID弯管
美标STD XS XXS

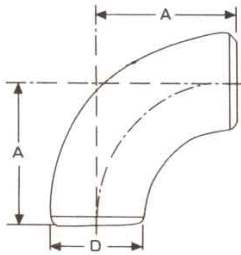

Short Radius 90° Elbows
1DBends 180°
ASME B16.9-1993

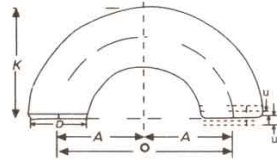

180° 1.5D弯管
美标STD XS XXS

1.5DBends 180°
ASME B16.9-1993

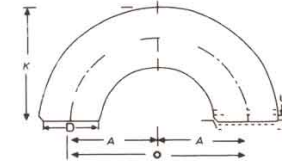

Nominal Pipe Size (NPS)	Outside Diameter at Bevel D		90 deg Elbows		180 deg Returns				Approx.Weight(kg) 重量					
			Center-to-Center A		Center-to-Center O		Back-to-Face K		90 deg Elbows			180 deg RETURNS		
	INCH	MM	INCH	MM	INCH	MM	INCH	MM	STD	XS	XXS	STD	XS	XXS
1	1.32	33	1.00	25	2.00	51	1.62	41	0.102			0.209		
1 1/4	1.66	42	1.25	32	2.50	64	2.06	52	0.174			0.350		
1 1/2	1.90	48	1.50	38	3.00	76	2.44	62	0.245	0.328		0.504	0.663	
2	2.38	60	2.00	51	4.00	102	3.19	81	0.434	0.594	1.08	0.899	1.23	
2 1/2	2.88	73	2.50	64	5.00	127	3.94	100	0.909	1.19	2.14	1.78	2.32	
3	3.50	89	3.00	76	6.00	152	4.75	121	1.36	1.83	3.31	2.78	3.69	
3 1/2	4.00	102	3.50	89	7.00	178	5.50	140	1.88	2.61		3.90	5.31	
4	4.50	114	4.00	102	8.00	203	6.25	159	2.56	3.58	6.54	5.27	7.31	
5	5.56	141	5.00	127	10.00	254	7.75	197	4.32	6.09	11.3	8.94	12.6	
6	6.62	168	6.00	152	12.00	305	9.31	237	6.63	10.0	18.5	13.9	20.7	
8	8.62	219	8.00	203	16.00	406	12.31	313	13.4	20.3	35.5	28.0	42.0	
10	10.75	273	10.00	254	20.00	508	15.38	391	23.6	31.8	63.6	49.5	66.7	
12	12.75	324	12.00	305	24.00	610	18.38	467	34.6	45.8	91.6	70.5	91.8	
14	14.00	356	14.00	356	28.00	711	21.00	533	45.3	60.0		90.6	122.8	
16	16.00	406	16.00	406	32.00	813	24.00	610	59.1	78.3		118.4	160	
18	18.00	457	18.00	457	36.00	914	27.00	686	75	99.9		142	200	
20	20.00	508	20.00	508	40.00	1016	30.00	762	93.1	124		186	248	
22	22.00	559	22.00	559	44.00	1118	33.00	838	113	150		226	298	
24	24.00	610	24.00	610	48.00	1219	36.00	914	135	179		270	358	

Nominal Pipe Size (NPS)	Outside Diameter at Bevel D		Center-to-Center O		Back-to-Face K		Approx Weight(kg) 重量		
	INCH	MM	INCH	MM	INCH	MM	STD	XS	XXS
1/2	0.84	21	3.00	76	1.88	48	0.159	0.204	
3/4	1.05	27	2.25	57	1.69	43	0.159	0.204	
1	1.32	33	3.00	76	2.19	56	0.313	0.400	
1 1/4	1.66	42	3.75	95	2.75	70	0.527	0.690	
1 1/2	1.90	48	4.50	114	3.25	83	0.758	1.00	
2	2.38	60	6.00	152	4.19	106	1.36	1.85	
2 1/2	2.88	73	7.50	191	5.19	132	2.67	3.50	
3	3.50	89	9.00	229	6.25	159	4.19	5.63	
3 1/2	4.00	102	10.50	267	7.25	184	5.90	7.99	
4	4.50	114	12.00	305	8.25	210	7.95	11.0	
5	5.56	141	15.00	381	10.31	262	13.5	19.0	
6	6.62	168	18.00	457	12.31	313	20.9	31.3	
8	8.62	219	24.00	610	16.31	414	41.9	63.6	
10	10.75	273	30.00	762	20.38	518	74.0	99.7	
12	12.75	324	36.00	914	24.38	619	108.7	143.6	
14	14.00	356	42.00	1067	28.00	711	141.9	187.9	
16	16.00	406	48.00	1219	32.00	813	186.0	246.6	
18	18.00	457	54.00	1372	36.00	914	236.2	313.5	
20	20.00	508	60.00	1524	40.00	1016	292.6	388.7	-
22	22.00	559	66.00	1676	44.00	1118	353.2	470.3	
24	24.00	610	72.00	1829	48.00	1219	422.2	560.1	

同径三通及管帽
美标STD XS XXS

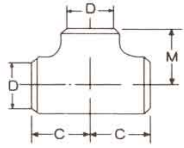

Equal tee and cap
ASME B16.9-1993

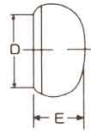

Nominal- Pipe Size (NPS)	Outside Diameter at Bevel D		Center-to-End						Approx.Weight(kg 重量)						
			Run C		Outlet M		Length E		STRAIGHT TEES			CAPS			
			INCH	MM	INCH	MM	INCH	MM	INCH	MM	STD	XS	XXS	STD	XS
1/2	0.84	21	1.00	25	1.00	25	1.00	25	0.114	0.163		0.047	0.062		
3/4	1.05	27	1.12	29	1.12	29	1.00	25	0.168	0.209		0.059	0.073		
1	1.32	33	1.50	38	1.50	38	1.50	38	0.345	0.422		0.104	0.127		
1 1/4	1.66	42	1.88	48	1.88	48	1.50	38	0.608	0.745		0.141	0.177		
1 1/2	1.90	48	2.25	57	2.25	57	1.50	38	0.917	1.126		0.168	0.218		
2	2.38	60	2.50	64	2.50	64	1.50	38	1.34	1.693	--	0.232	0.304		
2 1/2	2.88	73	3.00	76	3.00	76	1.50	38	2.37	2.92	4.54	0.368	0.463		
3	3.50	89	3.38	86	3.38	86	2.00	51	3.38	4.29	7.63	0.640	0.835		
3 1/2	4.00	102	3.75	95	3.75	95	2.50	64	4.47	5.72	9.63	0.962	1.29		
4	4.50	114	4.12	105	4.12	105	2.50	64	5.72	7.45	15.5	1.16	1.55		
5	5.56	141	4.88	124	4.88	124	3.00	76	8.99	12.0	23.9	1.91	2.61		
6	6.62	168	5.62	143	5.62	143	3.50	89	13.3	19.1	38.6	2.91	4.20		
8	8.62	219	7.00	178	7.00	178	4.00	102	24.4	34.7	69.0	5.13	7.40		
10	10.75	273	8.50	216	8.50	216	5.00	127	41.4	53.6		9.08	11.9		
12	12.75	324	10.00	254	10.00	254	6.00	152	53.6	69.5		13.4	17.3		
14	14.00	356	11.00	279	11.00	279	6.50	165	61.7	80.8		16.0	20.8		
16	16.00	406	12.00	305	12.00	305	7.00	178	66.1	87.7		20.1	26.2		
18	18.00	457	13.50	343	13.50	343	8.00	203	83.9	111		25.9	33.9		
20	20.00	508	15.00	381	15.00	381	9.00	229	104	138		32.6	42.6		
22	22.00	559	16.50	419	16.50	419	10.00	254	126	167		38.7	51.7		
24	24.00	610	17.00	432	17.00	432	10.50	267	139	185		45.0	60.1		
26	26.00	660	19.50	495	19.50	495	10.50	267	176	234		50.3	67.3	--	
28	28.00	711	20.50	521	20.50	521	10.50	267	192	256		56.0	74.9		
30	30.00	762	22.00	559	22.00	559	10.50	267	228	304		62.0	82.9		
32	32.00	812	23.50	597	23.50	597	10.50	267	249	331		68.3	91.2		
34	34.00	864	25.00	635	25.00	635	10.50	267	295	393		74.8	100		
36	36.00	914	26.50	673	26.50	673	10.50	267	334	441		81.7	109		
38	38.00	965	28.00	711	28.00	711	12.00	305	368	549		94	126		
40	40.00	1016	29.50	749	29.50	749	12.00	305	383	511		102	137		
42	42.00	1067	30.00	762	28.00	711	12.00	305	416	557		110	147		
44	44.00	1118	32.00	813	30.00	762	13.50	343	448	597		125	167		
46	46.00	1168	33.50	851	31.50	800	13.50	343	483	646		134	179		
48	48.00	1219	35.00	889	33.00	838	13.50	343	518	691		143	191		

美标异径三通及异径管 STD XS XXS

America standard reducing tee and reducer

ASME B16.9-1993

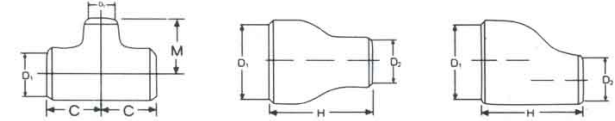

Nominal Pipe Size (NPS)	Outside Diameter at Bevel		Center-to-End				End-to-End		Approx Weight(kg)重量							
	D		D ₂		Run C		Outlet M		H		Reducing Outlet Tees			Reducers		
	INCH	MM	INCH	MM	INCH	MM	INCH	MM	INCH	MM	STD	XS	XXS	STD	XS	XXS
1/2x1/2	1.05	27	0.84	21	1.12	29	1.12	29	1.50	38	0.16	0.20		0.059	0.075	
1x1/4	1.32	33	1.05	27	1.50	38	1.50	38	2.00	51	0.32	0.40		0.116	0.147	0.246
1x1/2	1.32	33	0.84	21	1.50	38	1.50	38	2.00	51	0.30	0.39		0.105	0.133	0.215
1 1/4x1	1.66	42	1.32	33	1.88	48	1.88	48	2.00	51	0.57	0.71		0.157	0.206	0.350
1 1/4x1/2	1.66	42	1.05	27	1.88	48	1.88	48	2.00	51	0.54	0.67	--	0.143	0.187	0.310
1 1/4x1/4	1.66	42	0.84	21	1.88	48	1.88	48	2.00	51	0.51	0.65		0.130	0.170	
1 1/2x1 1/4	1.90	48	1.66	42	2.25	57	2.25	57	2.50	64	0.82	1.10		0.243	0.324	0.567
1 1/2x1	1.90	48	1.32	33	2.25	57	2.25	57	2.50	64	0.79	1.06		0.219	0.291	0.500
1 1/2x1/2	1.90	48	1.05	27	2.25	57	2.25	57	2.50	64	0.75	1.00		0.201	0.266	0.449
1 1/2x1/4	1.90	48	0.84	21	2.25	57	2.25	57	2.50	64	0.72	0.95		0.191	0.249	
2x1 1/2	2.38	60	1.90	48	2.50	64	2.38	60	3.00	76	1.19	1.63		0.372	0.508	0.909
2x1 1/4	2.38	60	1.66	42	2.50	64	2.25	57	3.00	76	1.11	1.52		0.352	0.479	0.851
2x1	2.38	60	1.32	33	2.50	64	2.00	51	3.00	76	1.07	1.46		0.322	0.438	0.765
2 1/2x1	2.88	73	1.66	42	2.50	64	2.25	57	3.50	89	1.38	1.81		0.290	0.412	
2 1/2x1/2	2.88	73	1.32	33	3.00	76	2.75	70	3.50	89	2.13	2.88	5.62	0.724	0.946	1.68
2 1/2x1 1/4	2.88	73	1.90	48	3.00	76	2.62	67	3.50	89	2.05	2.70	5.40	0.661	0.861	1.51
2 1/2x1 1/2	2.88	73	1.66	42	3.00	76	2.50	64	3.50	89	2.01	2.64		0.630	0.820	1.42
2 1/2x1 1/4	2.88	73	1.32	33	3.00	76	2.25	57	3.50	89	1.96	2.57		0.582	0.759	
3x2 1/2	3.50	89	2.88	73	3.38	86	3.25	83	3.50	89	3.28	4.19	8.38	0.933	1.25	2.25
3x2	3.50	89	2.38	60	3.38	86	3.00	76	3.50	89	3.12	3.89	7.78	0.846	1.13	2.01
3x1 1/2	3.50	89	1.90	48	3.38	86	2.88	73	3.50	89	2.88	3.78		0.783	1.04	1.83
3x1 1/4	3.50	89	1.66	42	3.38	86	2.75	70	3.50	89	2.81	3.73		0.750	1.00	
3 1/2x3	4.00	102	3.50	89	3.75	95	3.62	92	4.00	102	4.32	5.66		1.28	1.77	
3 1/2x2 1/2	4.00	102	2.88	73	3.75	95	3.50	89	4.00	102	4.14	5.47		1.23	1.65	
3 1/2x2	4.00	102	2.38	60	3.75	95	3.25	83	4.00	102	3.98	5.18		1.10	1.51	
3 1/2x1 1/2	4.00	102	1.90	48	3.75	95	3.12	79	4.00	102	3.74	5.07		1.02	1.41	
3 1/2x1 1/4	4.00	102	1.66	42					4.00	102				0.98	1.35	
4x3 1/2	4.50	114	4.00	102	4.12	105	4.00	102	4.00	102	5.62	7.26		1.54	2.14	
4x3	4.50	114	3.50	89	4.12	105	3.88	98	4.00	102	5.40	7.03	14.06	1.45	2.02	3.65
4x2 1/2	4.50	114	2.88	73	4.12	105	3.75	95	4.00	102	5.22	6.73	13.46	1.37	1.90	3.41
4x2	4.50	114	2.38	60	4.12	105	3.5	89	4.00	102	5.05	6.62	13.24	1.27	1.76	3.11
4 x1 1/2	4.50	114	1.90	48	4.12	105	3.38	86	4.00	102	4.81	6.51		1.19	1.65	
5x4	5.56	141	4.50	114	4.88	124	4.62	117	5.00	127	8.36	11.8	23.6	2.50	3.52	6.47
5x3 1/2	5.56	141	4.00	102	4.88	124	4.50	114	5.00	127	8.13	11.4		2.38	3.34	
5x3	5.56	141	3.50	89	4.88	124	4.38	111	5.00	127	7.95	11.2	22.4	2.27	3.18	5.78
5x2 1/2	5.56	141	2.88	73	4.88	124	4.25	108	5.00	127	7.79	10.9		2.16	3.02	5.46
5x2	5.56	141	2.38	60	4.88	124	4.12	105	5.00	127	7.58	10.7		2.02	2.82	

美标异径三通及异径管 STD XS XXS
America standard reducing tee and reducer

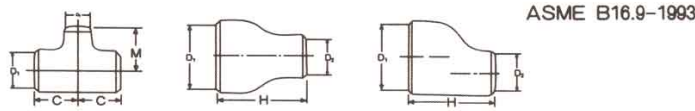

Nominal Pipe Size (NPS)	Outside Diameter at Bevel				Center-to-End				End-to-End H"		Approx.Weight(kg) 重量					
	D ₁		D ₂		Run C		Outlet M		H"		Reducing Outlet Tess			Reducers		
	INCH	MM	INCH	MM	INCH	MM	INCH	MM	INCH	MM	STD	XS	XXS	STD	XS	XXS
6x5	6.62	168	5.56	141	5.62	143	5.38	137	5.50	140	12.4	18.5	37.0	3.57	5.38	9.89
6x4	6.62	168	4.50	114	5.62	143	5.12	130	5.50	140	11.8	17.7	35.4	3.30	4.96	8.98
6x3 1/2	6.62	168	4.00	102	5.62	143	5.00	127	5.50	140	11.6	17.4		3.17	4.76	
6x3	6.62	168	3.5	89	5.62	143	4.88	124	5.50	140	11.4	17.2	34.4	3.04	4.56	8.21
6x2	6.62	168	2.88	73	5.62	143	4.75	121	5.50	140	11.3	16.9		2.91	4.36	7.83
8x6	8.62	219	6.62	168	7.00	178	6.62	168	6.00	152	22.7	30.2	60.4	5.71	8.61	14.3
8x5	8.62	219	5.56	141	7.00	178	6.38	162	6.00	152	22.0	29.3	58.6	5.4	8.13	13.4
8x4	8.62	219	4.50	114	7.00	178	6.12	156	6.00	152	21.4	28.5	57.0	5.1	7.67	12.6
8x3 1/2	8.62	219	4.00	102	7.00	178	6.00	152	6.00	152	21.0	27.9		4.96	7.45	
10x8	10.75	273	8.62	219	8.50	216	8.00	203	7.00	178	38.8	51.6		9.58	12.9	
10x6	10.75	273	6.62	168	8.50	216	7.62	194	7.00	178	37.1	49.3		8.78	11.8	
10x5	10.75	273	5.56	141	8.50	216	7.50	191	7.00	178	36.5	48.5		8.42	11.3	
10x4	10.75	273	4.50	114	8.50	216	7.25	184	7.00	178	35.9	47.7		8.05	10.71	
12x10	12.75	324	10.75	273	10.0	254	9.50	241	8.00	203	50.5	67.7		13.6	18.0	
12x8	12.75	324	8.62	219	10.0	254	9.00	229	8.00	203	48.3	64.7		12.7	16.7	
12x6	12.75	324	6.62	168	10.0	254	8.62	219	8.00	203	46.6	62.4		11.8	15.6	
12x5	12.75	324	5.56	141	10.0	254	8.50	216	8.00	203	46.0	61.6		11.3	15.0	
14x12	14.00	356	12.75	324	11.0	279	10.62	270	13.00	330	58.4	78.3		25.4	33.6	
14x10	14.00	356	10.75	273	11.0	279	10.12	257	13.00	330	55.0	73.7		23.6	31.2	
14x8	14.00	356	8.62	219	11.0	279	9.75	248	13.00	330	52.6	70.5		21.8	28.9	
14x6	14.00	356	6.62	168	11.0	279	9.38	238	13.00	330	50.8	68.1		19.8	26.3	
16x14	16.00	406	14.00	341	12.0	305	12.00	305	14.00	356	63.3	84.8		31.0	41.1	
16x12	16.00	406	12.75	324	12.0	305	11.62	295	14.00	356	61.1	81.9		29.6	39.2	
16x10	16.00	406	10.75	273	12.0	305	11.12	283	14.00	356	59.2	79.3		27.8	36.8	
16x8	16.00	406	8.62	219	12.0	305	10.75	273	14.00	356	58.0	77.7		24.7	32.9	
16x6	16.00	406	6.62	168	12.0	305	10.38	264			56.6	75.8				
18x16	18.00	457	16.00	406	13.5	343	13.00	330	15.00	381	78.9	105		37.8	50.1	
18x14	18.00	457	14.00	356	13.5	343	13.00	330	15.00	381	78.4	105		35.7	47.4	
18x12	18.00	457	12.75	324	13.5	343	12.62	321	15.00	381	78.1	104		34.3	45.5	
18x10	18.00	457	10.75	273	13.5	343	12.12	308	15.00	381	78.1	104		31.2	42.3	
18x8	18.00	457	8.62	219	13.5	343	11.75	298								
20x18	20.00	508	18.00	457	15.0	381	14.50	368	20.00	508	93.5	125		56.4	74.9	
20x16	20.00	508	16.00	406	15.0	381	14.00	356	20.00	508	93.0	124		53.5	71.1	
20x14	20.00	508	14.00	356	15.0	381	14.00	356	20.00	508	92.4	123		50.8	67.4	
20x12	20.00	508	12.75	324	15.0	381	13.62	346	20.00	508	92.4	123		47.6	63.3	
20x10	20.00	508	10.75	273	15.0	381	13.12	333			92.4	123				
20x8	20.00	508	8.62	219	15.0	381	12.75	324								
22x20	22.00	559	20.00	508	16.5	419	16.00	406	20.00	508	123	163		62.4	83.0	
22x18	22.00	559	18.00	457	16.5	419	15.50	394	20.00	508	120	159		59.6	79.2	
22x16	22.00	559	16.00	406	16.5	419	15.00	381	20.00	508	117	156		56.9	75.6	
22x14	22.00	559	14.00	356	16.5	419	15.00	381	20.00	508	117	156		53.2	70.8	
22x12	22.00	559	12.75	324	16.5	419	14.62	371			117	156				
22x10	22.00	559	10.75	273	16.5	419	14.12	359								

美标异径三通及异径管 STD XS XXS
America standard reducing tee and reducer

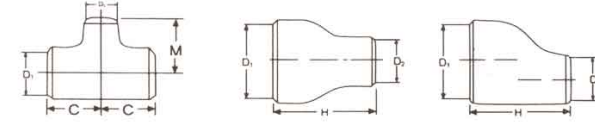

Nominal Pipe Size (NPS)	Outside Diameter at Bevel				Center-to-End				End-to-End H		Approx.Weight(kg) 重量					
	D ₁		D ₂		Run C		Outlet M		H		Reducing Outlet Tess			Reducers		
	INCH	MM	INCH	MM	INCH	MM	INCH	MM	INCH	MM	STD	XS	XXS	STD	XS	XXS
24x22	24.00	610	22.00	559	17.00	432	17.00	432	20.00	508	136	183		68.5	91.1	
24x20	24.00	610	20.00	406	17.00	432	17.00	432	20.00	508	136	183		65.7	87.3	
24x18	24.00	610	18.00	457	17.00	432	16.50	419	20.00	508	133	177		60.3	83.8	
24x16	24.00	610	16.00	406	17.00	432	16.00	406	20.00	508	133	177		60.3	83.8	
24x14	24.00	610	14.00	356	17.00	432	16.00	406			133	177				
24x12	24.00	610	12.75	324	17.00	432	15.62	397			133	177				
24x10	24.00	610	10.75	273	17.00	432	15.12	384								
26x24	26.00	660	24.00	610	19.50	495	19.00	483	24.00	610	172	229		89.4	119	
26x22	26.00	660	22.00	559	19.50	495	18.50	470	24.00	610	169	22.5		86.1	114	
26x20	26.00	660	20.00	508	19.50	495	18.00	457	24.00	610	166	221		82.7	110	
26x18	26.00	660	18.00	457	19.50	495	17.50	444	24.00	610	166	221		82.7	110	
26x16	26.00	660	16.00	406	19.50	495	17.00	432			166	221				
26x14	26.00	660	14.00	356	19.50	495	17.00	432			166	221				
26x12	26.00	660	12.75	324	19.50	495	16.62	422								
28x26	28.00	711	26.00	660	20.50	521	20.50	521			188	251		96.7	129	
28x24	28.00	711	24.00	610	20.50	521	20.00	508	24.00	610	183	244		93.3	124	
28x22	28.00	711	22.00	559	20.50	521	19.50	495	24.00	610	182	242		90.1	120	
28x20	28.00	711	20.00	508	20.50	521	19.00	483	24.00	610	182	242		90.1	120	
28x18	28.00	711	18.00	457	20.50	521	18.50	470	24.00	610						
28x16	28.00	711	16.00	406	20.50	521	18.00	457								
28x14	28.00	711	14.00	356	20.50	521	18.00	457								
28x12	28.00	711	12.75	324	20.50	521	17.62	448								
30x28	30.00	762	28.00	711	22.00	559	21.50	546			226	301		104	138	
30x26	30.00	762	26.00	660	22.00	559	21.50	546	24.00	610	222	296		101	134	
30x24	30.00	762	24.00	610	22.00	559	21.00	533	24.00	610	218	291		97.4	130	
30x22	30.00	762	22.00	559	22.00	559	20.50	521	24.00	610	218	291		97.4	130	
30x20	30.00	762	20.00	508	22.00	559	20.00	508	24.00	610						
30x18	30.00	762	18.00	457	22.00	559	19.50	495								
30x16	30.00	762	16.00	406	22.00	559	19.00	483								
30x14	30.00	762	14.00	356	22.00	559	19.00	483								
30x12	30.00	762	12.75	324	22.00	559	18.62	473								
30x10	30.00	762	10.75	273	22.00	559	18.12	460								
32x30	32.00	813	30.00	762	23.50	597	23.00	584	24.00	610	247	324		111	148	
32x28	32.00	813	28.00	711	23.50	597	22.50	572	24.00	610	240	319		106	144	
32x26	32.00	813	26.00	660	23.50	597	22.50	572	24.00	610	238	317		105	139	
32x24	32.00	813	24.00	610	23.50	597	22.00	559	24.00	610	238	317		105	139	
32x22	32.00	813	22.00	559	23.50	597	21.50	546								
32x20	32.00	813	20.00	508	23.50	597	21.00	533			</					

美标弯头、三通、弯管形位公差

Geometric tolerances of American standard elbow tee and bend

ASME B16.9-1993
ASME B16.28-1994

TOLERANCES

Nominal Pipe Size (NPS)	All Fittings			90 deg. and 45 deg. Elbows and Tees	Reducers	Caps	180 deg.Retrms		
	Outside Diameter at Bevel D	Inside Diameter at End	Wall Thickness t	Center-to-End Dimension A.B.C.M	Overall Length H	Overall Length E	Center-to-Center Dimension O	Back-to-Face Dimension K	Align-ment of Ends U
1/2 to 2 1/2	+0.06	0.03	Not less than 87.5% of nominal thickness	0.06	0.06	0.12	0.25	0.25	0.03
3 to 2 1/2	-0.03			0.06	0.06	0.12	0.25	0.25	0.03
4	0.06	0.06		0.06	0.06	0.12	0.25	0.25	0.03
5 to 8	0.06	0.06		0.06	0.06	0.12	0.25	0.25	0.03
	+0.09	0.06		0.06	0.06	0.25	0.25	0.25	0.03
10 to 18	-0.06			0.09	0.09	0.25	0.38	0.25	0.06
	+0.16	0.12		0.09	0.09	0.25	0.38	0.25	0.06
20 to 24	-0.12			0.09	0.09	0.25	0.38	0.25	0.06
	+0.2			0.09	0.09	0.25	0.38	0.25	0.06
26 to 30	-0.19	0.19		0.19	0.19	0.38
	+0.25		0.19	0.19	0.38	
32 to 48	0.19	0.19	0.19	0.19	0.38	
	+0.25	0.19	0.19	0.19	0.38	
	0.19								

Nominal Pipe Size (NPS)	Angularity TOL.	
	off Angle Q	off Plane P
1/2 to 4	0.03	0.06
5 to 8	0.06	0.12
10 to 12	0.09	0.19
14 to 16	0.09	0.25
18 to 24	0.12	0.38
26 to 30	0.19	0.38
32 to 42	0.19	0.5
44 to 48	0.19	0.75

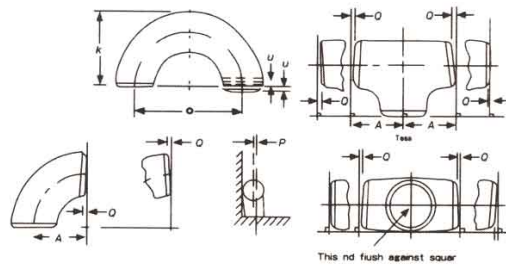

GENERAL NOTE:Dimensions are in inches. Tolerances are equal plus end minus except as noted.

美标管件端面坡口

End slope of America standard pipe fittings

ASME B16.9-1993
ASME B16.26-1994

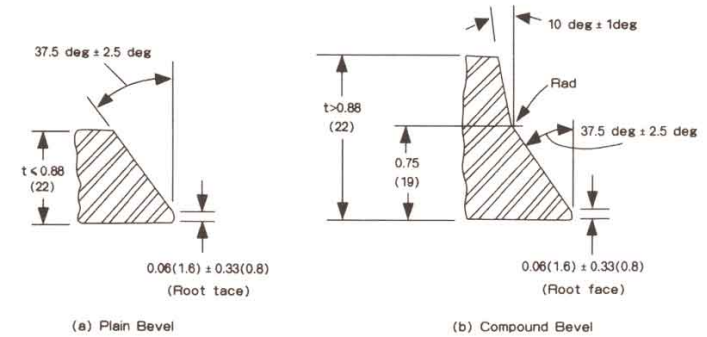

Nominal Wall Thickness t	End Preparation
Less than x [Note(1)]	Cut square or slightly chamfer at manufacture's option.
x to 0.88 incl. (22) [Note (1)]	Plain bevel as in sketch (a) above.
More than 0.88 (22)	Compound bevel as in sketch (b) above

GENERAL NOTES:

- (a) See ASME B16.25 for trnsitions from bevel and root face into body of fitting and backing ring preparations.
- (b) Dimensions in parentheses are in millimeters.

NOTE.

- (1) x =0.19(5) for carbon steel or ferritic alloy steel and 0.12(3) for austenitic alloy steel

FIG. 1 WELDING BEVEL AND ROOT FACE FOR FITTING (Without Backing Ring, or With Split Backing Ring)

日标弯头外径及壁厚

FSGP LG STD XS

Outside and Inside Diameters, and Thicknesses of Pipe Fittings FSGP and PY 400

JIS B2311-1997

Nominal diameter		Outside diameter	FSGP		LG		STD		XS	
A	B		Inside diameter	Thickne	Inside diameter	Thickness	Inside diameter	Thickness	Inside diameter	Thickness
15	1/2	21.7	16.1	2.8						
20	3/4	27.2	21.6	2.8						
25	1 1/4	34.0	27.6	3.2						
32	1 1/2	42.7	35.7	3.5						
40	1	48.6	41.6	3.5						
50	2	60.5	52.9	3.8						
65	2 1/2	76.3	67.9	4.2						
80	3	89.1	80.7	4.2						
90	3 1/2	101.6	93.2	4.2						
100	4	114.3	105.3	4.5						
125	5	139.8	130.8	4.5						
150	6	165.2	155.2	5.0	155.2	5				
200	8	216.3	204.7	5.8	204.7	5.8				
250	10	267.4	254.2	6.6	254.2	6.6				
300	12	318.5	304.7	6.9	304.7	6.9				
350	14	355.6	339.8	7.9	339.8	7.9				
400	16	406.4	390.6	7.9	390.6	7.9				
450	18	457.2	441.4	7.9	441.4	7.9				
500	20	508.0	492.2	7.9	492.2	7.9	499	9.5		
550	22	558.8			543.0	7.9	539.8	9.5	533.4	12.7
600	24	609.6			593.8	7.9	590.6	9.5	584.2	12.7
650	26	660.4			644.6	7.9	641.4	9.5	635.0	12.7
700	28	711.2			695.4	7.9	692.2	9.5	685.8	12.7
750	30	762.0			746.2	7.9	743.0	9.5	736.6	12.7
800	32	812.8			797.0	7.9	793.8	9.5	787.4	12.7
850	34	863.6			847.8	7.9	844.6	9.5	838.2	12.7
900	36	914.4			898.6	7.9	895.4	9.5	889.0	12.7
950	38	965.2			949.4	7.9	946.2	9.5	939.8	12.7
1000	40	1016.0			1000.2	7.9	997.0	9.5	990.6	12.7
1050	42	1066.8					1047.8	9.5	1041.4	12.7
1100	44	1117.6					1098.6	9.5	1092.2	12.7
1150	46	1168.4					1149.4	9.5	1143.0	12.7
1200	48	1219.2					1200.2	9.5	1193.8	12.7

日标45°、90°长半径、短半径弯头

JIS45°、90° Long Short Radius Elbows

JIS B2311-1997

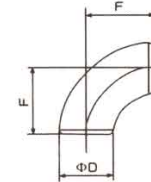
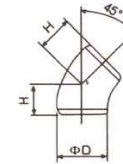

Nominal diameter		Outside diameter D	Dimension from the center line to the end face			Approx.Weight(kg) 重量		
			45° Elbows H	90° Elbows E		45° Elbows	90° Elbows	
A	B		Long	Long	Short	Long	Long	Short
15	1/2	21.7	15.8	38.1	-	0.039	0.078	-
20	3/4	27.2	15.8	38.1	-	0.050	0.100	-
25	1	34.0	15.8	38.1	25.4	0.073	0.146	0.097
32	1 1/4	42.7	19.7	47.6	31.8	0.126	0.252	0.168
40	1 1/2	48.6	23.7	57.2	38.1	0.175	0.350	0.233
50	2	60.5	31.6	76.2	50.8	0.317	0.634	0.423
65	2 1/2	76.3	39.5	95.3	63.5	0.56	1.12	0.75
80	3	89.1	47.3	114.3	76.2	0.79	1.58	1.05
90	3 1/2	101.6	55.3	133.4	88.9	1.06	2.11	1.41
100	4	114.3	63.1	152.4	101.6	1.46	2.91	1.94
125	5	139.8	78.9	190.5	127.0	2.25	4.49	2.99
150	6	165.2	94.7	228.6	152.4	3.55	7.09	4.73
200	8	216.3	126.3	304.8	203.2	7.20	14.40	9.60
250	10	267.4	157.8	381.0	254.0	12.70	25.40	16.93
300	12	318.5	189.4	457.2	304.8	19.05	38.10	25.40
350	14	355.6	220.9	533.4	355.6	28.35	56.70	37.80
400	16	406.4	252.5	609.6	406.4	37.15	74.30	49.53
450	18	457.2	284.1	685.8	457.2	47.10	94.20	62.79
500	20	508.0	315.6	762.0	508.0	59	117	78
550	22	558.8	347.2	838.2	558.8	71	141	94
600	24	609.6	378.7	914.4	609.6	84	168	112
650	26	660.4	410.3	990.6	660.4	99	198	132
700	28	711.2	441.9	1066.8	711.2	115	229	153
750	30	762.0	473.4	1143.0	762.0	132	264	176
800	32	812.8	505.0	1219.2	812.8	150	300	200
850	34	863.6	536.6	1295.4	863.6	169	338	225
900	36	914.4	568.1	1371.6	914.4	180	360	240
950	38	965.2	599.7	1447.8	965.2	212	424	283
1000	40	1016.0	631.2	1524.0	1016.0	235	470	313
1050	42	1066.8	662.8	1600.2	1066.8	259	518	345
1100	44	1117.6	694.4	1676.4	1117.6	284	569	379
1150	46	1168.4	725.9	1752.6	1168.4	311	622	415
1120	48	1219.2	757.5	1828.8	1219.2	339	677	451

日标180° 弯管及管帽
JIS180° Bends and cap

JIS B2311-1997

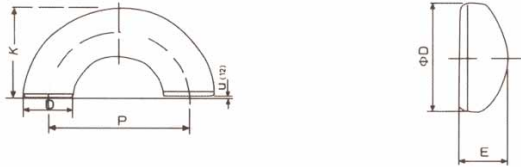

Nominal diameter		Outside diameter D	Centerline dimension		Dimension from the back to the end face		Approx.Weight (kg)重量			
			180° Elbows P		180° Elbows K		Caps E	180° Elbows K		Caps E
A	B		Long	Short	Long	Short			Long	
15	1/2	21.7	76.2	-	49.0	-	25.4	0.156	-	0.048
20	3/4	27.2	76.2	-	51.7	-	25.4	0.200	-	0.058
25	1	34.0	76.2	50.8	55.1	42.4	38.1	0.292	0.195	0.098
32	1 1/4	42.7	95.2	63.6	69.0	53.2	38.1	0.504	0.336	0.139
40	1 1/2	48.6	114.4	76.2	81.5	62.4	38.1	0.700	0.467	0.160
50	2	60.5	152.4	101.6	106.5	81.1	38.1	1.268	0.845	0.225
65	2 1/2	76.3	190.6	127.0	133.5	101.7	38.1	2.24	1.49	0.300
80	3	89.1	228.6	152.4	158.9	120.8	50.8	3.16	2.11	0.490
90	3 1/2	101.6	266.8	177.8	184.2	139.7	63.5	4.22	2.81	0.704
100	4	114.3	304.8	203.2	209.6	158.8	63.5	5.82	3.88	0.87
125	5	139.8	381.0	254.0	260.4	196.9	76.2	8.98	5.99	1.3
150	6	165.2	457.2	304.8	311.2	235.0	88.9	14.18	9.45	2.05
200	8	216.3	609.6	406.4	413.0	311.4	101.6	28.80	19.20	3.64
250	10	267.4	762.0	508.0	514.7	387.7	127.0	50.80	33.86	6.46
300	12	318.5	914.4	609.6	616.5	464.1	152.4	76.20	50.79	9.70
350	14	355.6	1066.8	711.2	711.2	533.4	165.1	113.40	75.59	13.26
400	16	406.4	1219.2	812.8	812.8	609.6	177.8	148.60	99.06	16.66
450	18	457.2	-	-	-	-	203.2	-	-	21.47
500	20	508.0	-	-	-	-	228.6	-	-	27.02

日标同径三通
JIS Equal tee

JIS B2311-1997

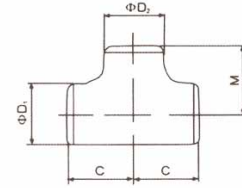

Nominal diameter		Outside diameter		Dimension from the centerline to the end face		Approx.Weight (kg) 重量
A	B	D1	D2	C	M	
15	1/2	21.7	21.7	25.4	25.4	0.12
20	3/4	27.2	27.2	28.6	28.6	0.17
25	1	34.0	34.0	38.1	38.1	0.32
32	1 1/4	42.7	42.7	47.6	47.6	0.56
40	1 1/2	48.6	48.6	57.2	57.2	0.78
50	2	60.5	60.5	63.5	63.5	1.16
65	2 1/2	76.3	76.3	76.2	76.2	1.94
80	3	89.1	89.1	85.7	85.7	2.55
90	3 1/2	101.6	101.6	95.3	95.3	3.23
100	4	114.3	114.3	104.8	104.8	4.27
125	5	139.8	139.8	123.8	123.8	6.17
150	6	165.2	165.2	142.9	142.9	9.32
200	8	216.3	216.3	177.8	177.8	17.5
250	10	267.4	267.4	215.9	215.9	29.7
300	12	318.5	318.5	254.0	254.0	32.0
350	14	355.6	355.6	279.4	279.4	44.7
400	16	406.4	406.4	304.8	304.8	55.2
450	18	457.2	457.2	342.9	342.9	70.0
500	20	508.0	508.0	381.0	381.0	86.6
550	22	558.8	558.8	419.1	419.1	106
600	24	609.6	609.6	431.8	431.8	116
650	26	660.4	660.4	495.3	495.3	147
700	28	711.2	711.2	520.7	520.7	165
750	30	762.0	762.0	558.8	558.8	190
800	32	812.8	812.8	596.9	596.9	217
850	34	863.6	863.6	635.0	635.0	245
900	36	914.4	914.4	673.1	673.1	276
950	38	965.2	965.2	711.2	711.2	308
1000	40	1016.0	1016.0	749.3	749.3	342
1050	42	1066.8	1066.8	762.0	711.2	351
1100	44	1117.6	1117.6	812.8	762.0	395
1150	46	1168.4	1168.4	850.9	800.1	433
1200	48	1219.2	1219.2	889.0	838.2	474

Remarks: The dimension M of 350 A(14B) or over in nominal diameter may be altered to smaller than that as given in the table above subject to the agreement between the parties concerned with delivery

日标异径三通及异径管
JIS standard reducing
tee and reducer

JIS B2311-1997

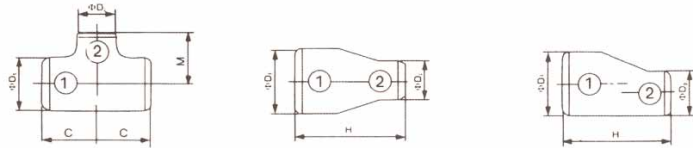

日标异径三通及异径管
JIS standard reducing
tee and reducer

JIS B2311-1997

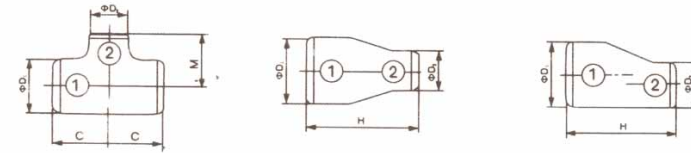

Nominal diameter 1 x 2		Outside diameter		Overall Length H	Dimension from the centerline to the end face		Approx.Weight(kg)	
A	B	D1	D2		C	M	Tees	Reducers
20X15	1/4X1/2	27.2	21.7	38.1	28.6	28.6	0.16	0.057
25X20	1X3/4	34.0	27.2	50.8	38.1	38.1	0.30	0.110
25X15	1X1/2	34.0	21.7	50.8	38.1	38.1	0.29	0.100
32X25	1 1/2X1	42.7	34.0	50.8	47.6	47.6	0.53	0.154
32X20	1 1/4X3/4	42.7	27.2	50.8	47.6	47.6	0.50	0.140
32X15	1 1/4X1/2	42.7	21.7	50.8	47.6	47.6	0.49	0.130
40X32	1 1/2X1 1/4	48.6	42.7	63.5	57.2	57.2	0.76	0.232
40X25	1 1/2 X1	48.6	34.0	63.5	57.2	57.2	0.72	0.209
40X20	1 1/2 X3/4	48.6	27.2	63.5	57.2	57.2	0.68	0.191
40X15	1 1/2 X1/2	48.6	21.7	63.5	57.2	57.2	0.67	0.180
50X40	2X1 1/2	60.5	48.6	76.2	63.5	60.3	1.08	0.364
50X32	2X1 1/4	60.5	42.7	76.2	63.5	57.2	1.04	0.344
50X25	2X1	60.5	34.0	76.2	63.5	50.8	0.99	0.315
50X20	2X3/4	60.5	27.2	76.2	63.5	44.5	0.95	0.290
65X50	2 1/2 X2	76.3	60.5	88.9	76.2	69.9	1.78	0.594
65X40	2 1/2 X1 1/2	76.3	48.5	88.9	76.2	66.7	1.70	0.543
65X32	2 1/2 X1 1/4	76.3	42.7	88.9	76.2	63.5	1.67	0.518
65X25	2 1/2 X1	76.3	34.0	88.9	76.2	57.2	1.61	0.480
80X65	3X2 1/2	89.1	76.3	88.9	85.7	82.6	2.44	0.725
80X50	3X2	89.1	60.5	88.9	85.7	76.2	2.28	0.658
80X40	3X1 1/2	89.1	48.6	88.9	85.7	73.0	2.21	0.611
80X32	3X1 1/4	89.1	42.7	88.9	85.7	69.0	2.17	0.590
90X80	3 1/2 X3	101.6	89.1	101.6	95.3	92.1	3.12	0.961
90X65	3 1/2 X2 1/2	101.6	76.3	101.6	95.3	88.9	3.01	0.899
90X50	3 1/2 X2	101.6	60.5	101.6	95.3	82.6	2.85	0.826
90X40	3 1/2 X1 1/2	101.6	48.6	101.6	95.3	79.4	2.77	0.771
90X32	3 1/2 X1 1/4	101.6	42.7	101.6	-	-	-	0.740
100X90	4X3 1/2	114.3	101.6	101.6	104.8	101.6	4.09	1.17
100X80	4X3	114.3	89.1	101.6	104.8	98.4	3.98	1.1

Nominal diameter 1 x 2		Outside diameter		Overall Length H	Dimension from the centerline to the end face		Approx.Weight(kg) 重量	
A	B	D1	D2		C	M	Tees	Reducers
100X65	4X2 1/2	114.3	76.3	101.6	104.8	95.3	3.87	1.04
100X50	4X2	114.3	60.5	101.6	104.8	88.9	3.71	0.967
100X40	4X1 1/2	114.3	48.6	101.6	104.8	85.7	3.63	0.910
125X100	5X4	139.8	114.3	127.0	123.8	117.5	5.86	1.74
125X90	5X3 1/2	139.8	101.6	127.0	123.8	114.3	5.68	1.65
125X80	5X3	139.8	89.1	127.0	123.8	111.1	5.56	1.58
125X65	5X2 1/2	139.8	76.3	127.0	123.8	108.0	5.45	1.50
125X50	5X2	139.8	60.5	127.0	123.8	104.8	5.32	1.41
150X125	6X5	165.2	139.8	139.7	142.9	136.5	8.80	2.55
150X100	6X4	165.2	114.3	139.7	142.9	130.2	8.49	2.36
150X90	6X3 1/2	165.2	101.6	139.7	142.9	127.0	8.31	2.27
150X80	6X3	165.2	89.1	139.7	142.9	123.8	8.19	2.18
150X65	6X2 1/2	165.2	76.3	139.7	142.9	120.7	8.08	2.09
200X150	8X6	216.3	165.2	152.4	177.8	168.3	16.2	4.17
200X125	8X5	216.3	139.8	152.4	177.8	161.9	15.7	3.87
200X100	8X4	216.3	114.3	152.4	177.8	155.6	15.4	3.67
200X90	8X3	216.3	101.6	152.4	177.8	152.4	15.2	3.56
250X200	10X8	267.4	216.3	177.8	215.9	203.2	27.8	6.87
250X150	10X6	267.4	165.2	177.8	215.9	193.7	26.6	6.32
250X125	10X5	267.4	139.8	177.8	215.9	190.5	26.1	6.06
250X100	10X4	267.4	114.3	177.8	215.9	184.2	25.8	5.80
300X250	12X10	318.5	267.4	203.2	254.0	241.3	41.5	9.97
300X200	12X8	318.5	216.3	203.2	254.0	228.6	39.6	9.29
300X150	12X6	318.5	165.2	203.2	254.0	219.1	38.3	8.69
300X125	12X5	318.5	139.8	203.2	254.0	215.9	37.9	8.39
350X300	14X12	355.6	318.5	330.2	279.4	269.9	42.7	21.2
350X250	14X10	355.6	267.4	330.2	279.4	257.2	41.2	19.7
350X200	14X8	355.6	216.3	330.2	279.4	247.7	40.0	18.3
350X150	14X6	355.6	165.2	330.2	279.4	238.1	39.0	16.9

日标异径三通及异径管

JIS standard reducing tee and reducer

JIS B2311-1997

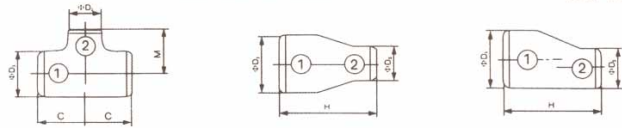

日标异径三通及异径管

JIS standard reducing tee and reducer

JIS B2311-1997

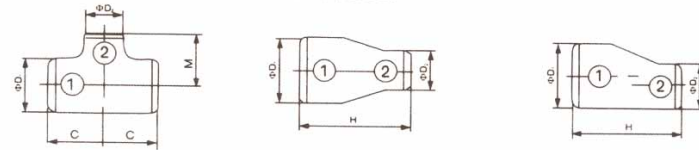

Unit mm

Nominal diameter 1 x 2		Outside diameter		Overall Length H	Dimension from the centerline to the end face		Approx. weight(kg) 重量	
A	B	D1	D2		C	M	Tees	Reducers
400 x 350	16 x 14	406.4	355.6	355.6	304.8	304.8	54.2	25.9
400 x 300	16 x 12	406.4	318.5	355.6	304.8	295.3	52.2	24.7
400 x 250	16 x 10	406.4	267.4	355.6	304.8	282.6	50.7	23.2
400 x 200	16 x 8	406.4	216.3	355.6	304.8	373.1	49.4	21.7
400 x 150	16 x 6	406.4	165.2	355.6	304.8	263.5	48.5	
450 x 400	18 x 16	457.2	406.4	381.0	342.9	330.2	67.9	31.5
450 x 350	18 x 14	457.2	355.6	381.0	342.9	330.2	66.9	29.8
450 x 300	18 x 12	457.2	318.5	381.0	342.9	320.7	64.9	28.6
450 x 250	18 x 10	457.2	267.4	381.0	342.9	308.0	63.4	27.1
500 x 450	20 x 18	508.0	457.2	508.0	381.0	368.3	84.2	47.0
500 x 400	20 x 16	508.0	406.4	508.0	381.0	355.6	82.1	44.7
500 x 350	20 x 14	508.0	355.6	508.0	381.0	355.6	81.1	42.4
500 x 300	20 x 12	508.0	318.5	508.0	381.0	346.1	79.1	40.8
500 x 250	20 x 10	508.0	267.4	508.0	381.0	333.4	77.6	
500 x 200	20 x 8	508.0	216.3	508.0	381.0	323.9	76.3	
550 x 500	22 x 20	558.8	508.3	508.0	419.1	406.4	103	52.0
550 x 450	22 x 18	558.8	457.2	508.0	419.1	393.7	101	49.7
550 x 400	22 x 16	558.8	406.4	508.0	419.1	381.0	98.9	47.5
550 x 350	22 x 14	558.8	355.6	508.0				45.3
600 x 550	24 x 22	609.6	558.8	508.0	431.8	431.8	115	57.1
600 x 500	24 x 20	609.6	508.0	508.0	431.8	431.8	114	54.8
600 x 450	24 x 18	609.6	457.2	508.0	431.8	419.1	111	52.6
600 x 400	24 x 16	609.6	406.4	508.0				50.4
650 x 600	26 x 24	660.4	609.6	609.6	495.3	482.6	144	74.5
650 x 550	26 x 22	660.4	558.8	609.6	495.3	469.8	141	71.7
650 x 500	26 x 20	660.4	508.0	609.6	495.3	457.2	138	68.9
650 x 450	26 x 18	660.4	457.2	609.6				66.3
700 x 650	28 x 26	711.2	660.4	609.6	520.7	520.7	164	80.5
700 x 600	28 x 24	711.2	609.6	609.6	520.7	508.0	161	77.7
700 x 550	28 x 22	711.2	558.8	609.6	520.7	495.3	158	75.0
700 x 500	28 x 20	711.2	508.0	609.6				72.4
750 x 700	30 x 28	762.0	711.2	609.6	558.8	546.1	188	86.6
750 x 650	30 x 26	762.0	660.4	609.6	558.8	546.1	185	83.8
750 x 600	30 x 24	762.0	609.6	609.6	558.8	533.4	182	81.1
750 x 550	30 x 22	762.0	558.8	609.6				78.5
800 x 750	32 x 30	812.8	762.0	609.6	596.9	584.2	213	92.6
800 x 700	32 x 28	812.8	711.2	609.6	596.9	571.5	210	89.8

Unit: mm

Nominal diameter 1 x 2		Outside diameter		Overall Length H	Dimension from the centerline to the end face		Approx.Weight(kg) 重量	
A	B	D1	D2		C	M	Tees	Reducers
800x650	32x26	812.8	660.4	609.6	596.9	571.5	208	87.2
800x600	32x24	812.8	609.6	609.6	-	-	-	84.6
850x800	34x32	863.6	812.8	609.6	635.0	622.3	243	98.6
850x750	34x30	863.6	762.0	609.6	635.0	609.6	238	95.9
850x700	34x28	863.6	711.2	609.6	635.0	596.9	236	93.2
850x650	34x26	863.6	660.4	609.6	-	-	-	90.7
900x850	36x34	914.4	863.6	609.6	673.1	660.4	271	105
900x800	36x32	914.4	812.8	609.6	673.1	647.7	269	102
900x750	36x30	914.4	762.0	609.6	673.1	635.0	264	99.3
900x700	36x28	914.4	711.2	609.6	-	-	-	96.8
950x900	38x36	965.2	914.4	609.6	711.2	711.2	306	111
950x850	38x34	965.2	863.6	609.6	711.2	698.5	301	108
950x800	38x32	965.2	812.8	609.6	711.2	685.8	297	105
950x750	38x30	965.2	762.0	609.6	-	-	-	103
1000x950	40x38	1016.0	965.2	609.6	749.3	749.3	339	117
1000x900	40x36	1016.0	914.4	609.6	749.3	736.6	335	114
1000x850	40x34	1016.0	863.6	609.6	749.3	723.9	330	111
1000x800	40x32	1016.0	812.8	609.6	-	-	-	109
1050x1000	42x40	1066.8	1016.0	609.6	762.0	711.2	349	123
1050x950	42x38	1066.8	965.2	609.6	762.0	711.2	348	120
1050x900	42x36	1066.8	914.4	609.6	762.0	711.2	346	118
1050x850	42x34	1066.8	863.6	609.6	-	-	-	115
1100x1050	44x42	1117.6	1066.8	609.6	812.8	762.0	393	129
1100x1000	44x40	1117.6	1016.0	609.6	812.8	749.3	389	126
1100x950	44x38	1117.6	965.2	609.6	812.8	736.6	385	121
1100x900	44x36	1117.6	914.4	609.6	-	-	-	119
1500x1100	46x44	1168.4	1117.6	711.2	850.9	800.1	431	157
1500x1050	46x42	1168.4	1066.8	711.2	850.9	787.4	427	154
1500x1000	46x40	1168.4	1016.0	711.2	850.9	774.7	422	151
1150x950	46x38	1168.4	965.2	711.2	-	-	-	148
1200x1150	48x46	1219.2	1168.4	711.2	809.0	838.2	471	164
1200x1100	48x44	1219.2	1117.6	711.2	809.0	838.2	469	161
1200x1050	48x42	1219.2	1066.8	711.2	809.0	812.8	461	158
1200x1000	48x40	1219.2	1016.0	711.2	-	-	-	155

日标管件端头坡口尺寸

Dimensional Tolerances and Permissible Values

JIS B2311-1997

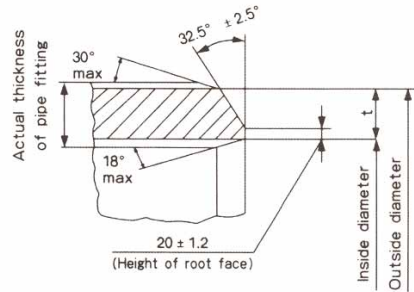

Fig.2 Shape and dimensions of bevel end

Unit: mm

Item	Types of pipe fittings	Nominal diameter							
		A	15 to 65	80 to 100	125 to 200	250 to 450	500 to 600	650 to 750	800 to 1200
		B	1/2 to 2	3 to 4	5 to 8	10 to 18	20 to 24	26 to 30	32 to 48
		Tolerance							
Outside diameter at end	All types of cocoe fittings		± 2.0	± 2.5	± 3.5	± 5.0	± 6.4	± 6.4	± 6.4
Inside diameter at end face			± 2.0	± 2.5	± 3.5	± 4.5	-4.5	-4.8	± 4.8
Thickness		-not specified							
		15%							
Bevel angle		See Fig.2							
Height of root face		See Fig.2							
Dimension from center line to end face(HF)	45° elbows 90° elbows		± 2.0			± 3.2			± 4.8
Centerline dimension(P)	180° elbows		± 6.4		± 9.5				
Dimension from back to end face(K)			± 6.4						
Alignment of end faces (U)(max.)			1.6		3.2				
Overall length (H)	Reducers		± 2.0			± 3.2			± 4.8
Dimension from center line to end face(C.M)	Tees		± 2.0			± 3.2			± 4.8
Dimension from back to end face(E)	Caps		± 3.2			± 6.4			
Outer peripheral length at end	All types of pipe fittings								± 0.5%

- Remarks 1 For the dimensional tolerances for H of reducers and M of reducing tees, the tolerances specified for the larger diameter side shall apply
 2 For the galvanized part of white pipe fittings, the above-mentioned tolerances shall be applicable before galvanizing

日标弯头三通形位公差

Tolerances on Alignment of Pipe Fittings

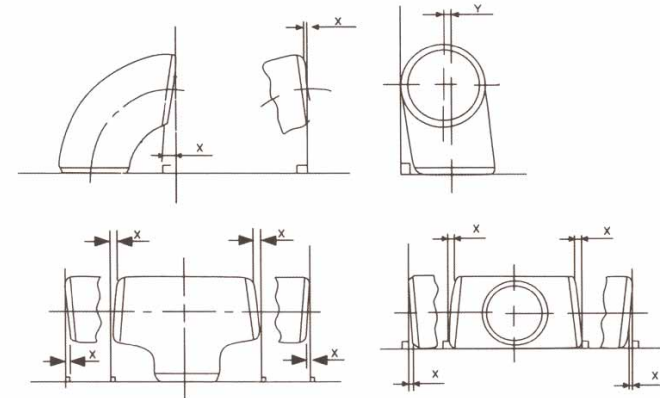

Item	Types of pipe fittings	Nominal diameter									
		A	15 to 100	125 to 200	250 to 300	350 to 400	450 to 600	650 to 750	800 to 1050	110 to 1200	
		B	1/2 to 4	5 to 8	10 to 12	14 to 16	18 to 24	26 to 30	32 to 42	44 to 48	
		Tolerance									
Off angle(X)	Elbows, reducers, tees		0.8	1.6	2.4	3.2	4.8				
Off angle(Y)	Elbows, tees		1.6	3.2	4.8	6.4	9.5	12.7	19.1		

- Remarks 1 For the tolerances on alignment of reducers and reducing tees, the tolerances specified for larger diameter side shall apply
 2 For the galvanized part of white pipe fittings, the above-mentioned tolerances shall be applicable before galvanizing.

德标管件各部尺寸

Dimensions of Germany standard pipe fittings

DIN2605-1991
DIN2617-1991

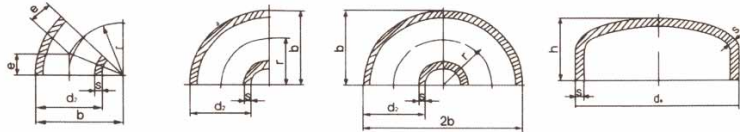

Nominal-Size DN	Outside Diameter da	Wall Thickness s, for series 3	r	b	e	h	Approx. Weight(kg) 重量			
							45° Elbows	90° Elbows	180° Elbows	Caps
15	21.3	2.0	28.0	38	12	25	0.02	0.04	0.08	0.02
20	26.9	2.3	29.0	43	12	25	0.04	0.07	0.14	0.04
25	33.7	2.6	38.0	56	16	38	0.06	0.12	0.24	0.07
32	42.4	2.6	48.0	69	20	38	0.10	0.19	0.38	0.11
40	48.3	2.6	57.0	82	24	38	0.14	0.27	0.54	0.14
50	60.3	2.9	76	106	32	38	0.25	0.49	0.98	0.26
65	76.1	2.9	95	133	39	38	0.40	0.79	1.58	0.34
80	88.9	3.2	114	159	47	51	0.61	1.22	2.44	0.50
100	114.3	3.6	152	210	63	64	1.19	2.37	4.74	1.07
125	139.7	4.0	190	260	79	76	2.02	4.04	8.08	1.55
150	168.3	4.5	229	313	95	89	3.25	6.50	13.00	2.65
200	219.1	5.9	305	414	126	102	7.95	15.9	31.8	5.60
250	273	6.3	381	518	158	127	12.45	24.9	49.8	8.10
300	323.9	7.1	457	619	189	152	20	40	80	11.75
350	355.6	8.0	533	711	221	165	28.6	57.2	114.4	16.12
400	406.4	8.8	610	813	253	178	41.1	82.2	164.4	22.27
450	457	10	686	914	284	203	60	119	238	32.61
500	508	11	762	1016	316	229	81	162	324	45.15
600	610	12.5	914	1219	379	267	136	271	542	70.83
700	711	12.5	1067	1422	422	267	177	353	706	88.14
800	813	12.5	1219	1626	505	267	231	461	922	107.5
900	914	12.5	1372	1829	568	267				128.59
1000	1016	12.5	1524	2032	631	305				160.55
1200	1220		1830	2440	758	343				

TOLERANCES

Nominal-Size DN	Limit Deviations for Dimension				Lower Limit Deviations for Wall Thickness	
	45° Elbows b	90° Elbows b	180° Elbows 2b	Caps h	+15%/-12.5% for all sizes and wall thickness	+15% -0.50mm
15-65	+/-6.0	+/-2.5	+/-8.0	+/-4		
80-100	+/-7.0	+/-3.0	+/-9.0	+/-4		
125-200	+/-8.5	+/-3.5	+/-10.0	+/-7		
250	+/-9.5	+/-4.0	+/-14.0	+/-7		
300-450	+/-12.0	+/-5.0	+/-14.0	+/-7		
500-600	+/-14.5	+/-6.0	+/-16.0	+/-7		
700	+/-14.5	+/-6.0	To Be Agreed	+/-10		
800-1200	+/-19.0	+/-8.0	Agreed	+/-10		

德标三通及异径管尺寸

Dimensions of Germany standard reducing tee and reducer

DIN2615-1992
DIN2616-1991

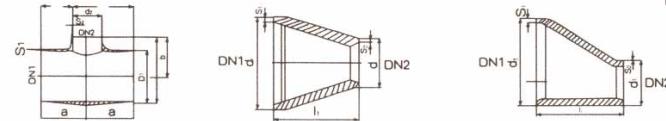

Nominal Size DN1	Outside Diameter d1	Wall Thickness s1 for series 3	Nominal Size DN 2	Nominal Size d2	Wall Thickness s2 for series 3	Tees		Reducers		Approx.Weight(kg) 重量	
						a	b	l1	Tees	Reducers	
15	21.3	2.0	15	21.3	2.0	25	25	-	0.09	-	-
20	26.9	2.3	20	26.9	2.3	29	29	-	0.15	-	-
20	26.9	2.3	15	21.3	2.0	29	29	38	0.13	0.042	-
25	33.7	2.6	25	33.7	2.6	38	38	-	0.29	-	-
25	33.7	2.6	20	26.9	2.3	38	38	50	0.29	0.097	-
25	33.7	2.6	15	21.3	2.0	38	38	50	0.29	0.09	-
32	42.4	2.6	32	42.4	2.6	48	48	-	0.50	-	-
32	42.4	2.6	25	33.7	2.6	48	48	50	0.46	0.12	-
32	42.4	2.6	20	26.9	2.3	48	48	50	0.46	0.12	-
32	42.4	2.6	15	21.3	2.0	48	48	50	0.46	0.12	-
40	48.3	2.6	40	48.3	2.6	57	57	-	0.70	-	-
40	48.3	2.6	32	42.4	2.6	57	57	64	0.66	0.19	-
40	48.3	2.6	25	33.7	2.6	57	57	64	0.65	0.185	-
40	48.3	2.6	20	26.9	2.3	57	57	64	0.65	0.165	-
50	60.3	2.9	50	60.3	2.9	64	64	-	1.04	-	-
50	60.3	2.9	40	48.3	2.6	64	60	76	0.97	0.31	-
50	60.3	2.9	32	42.4	2.6	64	57	76	0.96	0.31	-
50	60.3	2.9	25	33.7	2.6	64	51	76	0.96	0.29	-
50	60.3	2.9	20	26.9	2.3	64	44	76	0.96	0.29	-
65	76.1	2.9	65	76.1	2.9	76	76	-	2.00	-	-
65	76.1	2.9	50	60.3	2.9	76	70	90	1.80	0.53	-
65	76.1	2.9	40	48.3	2.6	76	67	90	1.50	0.48	-
65	76.1	2.9	32	42.4	2.6	76	64	90	1.50	0.48	-
65	76.1	2.9	25	33.7	2.6	76	57	90	1.50	0.48	-
80	88.9	3.2	80	88.9	3.2	89	86	-	2.20	-	-
80	88.9	3.2	65	76.1	2.9	89	83	90	2.00	0.62	-
80	88.9	3.2	50	60.3	2.9	89	76	90	2.00	0.62	-
80	88.9	3.2	40	48.3	2.6	89	73	90	2.00	0.56	-
80	88.9	3.2	32	42.4	2.6	89	70	90	2.00	0.53	-
100	114.3	3.6	100	114.3	3.6	105	105	-	4.00	-	-
100	114.3	3.6	80	88.9	3.2	105	98	100	3.50	0.97	-
100	114.3	3.6	65	76.1	2.9	105	95	100	3.50	0.97	-
100	114.3	3.6	50	60.3	2.9	105	89	100	3.50	0.97	-
100	114.3	3.6	40	48.3	2.6	105	86	100	6.50	0.80	-
125	139.7	4.0	125	139.7	4.0	124	124	-	6.50	-	-
125	139.7	4.0	100	114.3	3.6	124	117	127	6.50	1.71	-
125	139.7	4.0	80	88.9	3.2	124	111	127	6.50	1.71	-
125	139.7	4.0	65	76.1	2.9	124	108	127	6.50	1.71	-
125	139.7	4.0	50	60.3	2.9	124	105	127	6.50	1.71	-
150	168.3	4.5	150	168.3	4.5	143	143	-	10.50	-	-
150	168.3	4.5	125	139.7	4.0	143	137	140	10.50	2.53	-
150	168.3	4.5	100	114.3	3.6	143	130	140	10.00	2.53	-
150	168.3	4.5	80	88.9	3.2	143	124	140	10.00	2.53	-
150	168.3	4.5	65	76.1	2.9	143	121	140	10.00	2.53	-

德标三通及异径管尺寸

Dimensions of Germany standard reducing tee and reducer

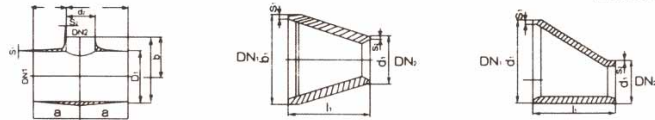

DIN2615-1992
DIN2616-1991

Nominal Size DN1	Outside Diameter d1	Wall Thickness s1 for series 3	Nominal size DN 2	Nominal size d2	Wall Thickness s2 for series 3	Tees		Reducers		Approx. Weight(kg) 重量	
						a	b	11	Tees	Reducers	
200	219.1	6.3	200	219.1	6.3	178	178			19.0	
200	219.1	6.3	150	168.3	4.5	178	168	152	18.0	5.03	
200	219.1	6.3	125	139.7	4.0	178	162	152	18.0	5.03	
200	219.1	6.3	100	114.3	3.6	178	156	152	18	5.03	
200	219.1	6.3	80	88.9	3.2	178	152	152	18.0	5.03	
250	273	6.3	250	273	6.3	216	216			40.0	
250	273	6.3	200	219.1	6.3	216	203	178	37.0	7.40	
250	273	6.3	150	168.3	4.5	216	194	178	36.0	7.40	
250	273	6.3	125	139.7	4.0	216	191	178	36.0	7.40	
250	273	6.3	100	114.3	3.6	216	184	178	36.0	7.40	
300	323.9	7.1	300	323.9	7.1	254	254			62.0	
300	323.9	7.1	250	273	6.3	254	241	203	62.0	11.29	
300	323.9	7.1	200	219.1	6.3	254	229	203	62.0	11.29	
300	323.9	7.1	150	168.3	4.5	254	219	203	49.0	11.29	
300	323.9	7.1	125	139.7	4.0	254	216	203	49.0	11.29	
350	355.6	8.0	350	355.6	8.0	279	279			77.0	
350	355.6	8.0	300	323.9	7.1	279	270	330	77	22.54	
350	355.6	8.0	250	273	6.3	279	257	330	72.0	22.54	
350	355.6	8.0	200	219	6.3	279	248	330	72.0	22.54	
350	355.6	8.0	150	168.3	4.5	279	238	330	72.0	22.54	
400	406.4	8.8	400	406.4	8.8	305	305			94	
400	406.4	8.8	350	355.6	8.0	305	305	355	94	30.49	
400	406.4	8.8	300	323.9	7.1	305	295	355	88	30.49	
400	406.4	8.8	250	273	6.3	305	283	355	88	30.49	
400	406.4	8.8	200	219.1	6.3	305	273	355	88	30.49	
400	406.4	8.8	150	168.3	4.5	305	264	355	88	30.49	
450	457	10	450	457	10	343	343			125	
450	457	10	400	406.4	8.8	343	330	381	125	41.91	
450	457	10	350	355.6	8.0	343	330	381	120	41.91	
450	457	10	300	323.9	7.1	343	321	381	120	41.91	
450	457	10	250	273	6.3	343	308	381	120	41.91	
450	457	10	200	219.1	6.3	343	298	381	120	41.91	
500	508	11	500	508	11	381	381			228	
500	508	11	450	457	10	381	368	508	228	68.58	
500	508	11	400	406.4	8.8	381	356	508	228	68.58	
500	508	11	350	355.6	8.0	381	356	508	224	68.58	
500	508	11	300	323.9	7.1	381	246	508	224	68.58	
500	508	11	250	273	6.3	381	333	508	219	68.58	
500	508	11	200	219.1	6.3	381	324	508	219	68.58	
600	610	12.5	600	610	12.5	432	432			423	

德标三通异径管尺寸

Dimensions of Germany standard reducing tee and reducer

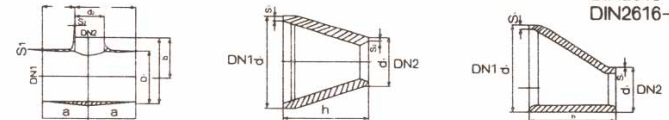

DIN2615-1992
DIN2616-1991

Nominal Size DN1	Outside Diameter d1	Wall Thickness s1 for series 3	Nominal Size DN2	Nominal Size d2	Wall Thickness s2 for series 3	Tees		Reducers	Approx. Weight(kg) 重量		
						a	b		h	Tees	Reducers
600	610	12.5	500	508	11	432	432	508	309	97.03	
600	610	12.5	450	457	10	432	419	508	309	97.03	
600	610	12.5	400	406.4	8.8	432	406	508	231	97.03	
600	610	12.5	350	355.6	8.0	432	406	508	231	97.03	
600	610	12.5	300	323.9	7.1	432	397	508	231	97.03	
600	610	12.5	250	273	6.3	432	384	508	231	97.03	
700	711	12.5	700	711	12.5	521	521				
700	711	12.5	600	610	12.5	521	508	610			
700	711	12.5	500	508	11	521	483	610			
700	711	12.5	450	457	10	521	470	610			
700	711	12.5	400	406.4	8.8	521	457	610			
700	711	12.5	350	355.6	8.0	521	457	610			
700	711	12.5	300	323.9	7.1	521	448	610			
800	813	12.5	800	813	12.5	597	597				
800	813	12.5	700	711	12.5	597	572	610			
800	813	12.5	600	610	12.5	597	559	610			
800	813	12.5	500	508	11	597	533	610			
800	813	12.5	450	457	10	597	521	610			
800	813	12.5	400	406.4	8.8	597	508	610			
800	813	12.5	350	355.6	8.0	597	508	610			
900	914	12.5	900	914	12.5	673	673				
900	914	12.5	800	813	12.5	673	648	610			
900	914	12.5	700	711	12.5	673	622	610			
900	914	12.5	600	610	12.5	673	610	610			
900	914	12.5	500	508	11	673	584	610			
900	914	12.5	450	457	10	673	572	610			
900	914	12.5	400	406.4	8.8	673	559	610			
1000	1016	12.5	1000	1016	12.5	749	749				
1000	1016	12.5	900	914	12.5	749	737	610			
1000	1016	12.5	800	813	12.5	749	711	610			
1000	1016	12.5	700	711	12.5	749	673	610			
1000	1015	12.5	600	610	12.5	749	660	610			
1000	1016	12.5	500	508	11	749	635	610			
1000	1016	12.5	450	457	10	749	622	610			

Nominal Size DN	Limit Deviations for Dimension		Lower Limit Deviations for Wall Thickness	
	Tees a and b	Reducers h	Tees	Reducers
15-65	+/-2.0	+/-2.5	15%	12.5%
80-100				
125-200				
250				
300-450	+/-3.0	+/-5.0	15%	12.5%
500-600				
600-700				
800	+/-5.0	+/-8.0	+15%	-0.50mm
900-1000				